

#### START FROM HERE

- Make sure power is completely off at the fuse box.
- Have your fixture installed by a qualified registered electrician
- Prepare everything in clear area.
- Wear gloves at all times during this installation.
- Read instructions carefully before you start assembly.
- Keep this instruction sheet for future reference.

**Technical Support:** 0800-67-72574

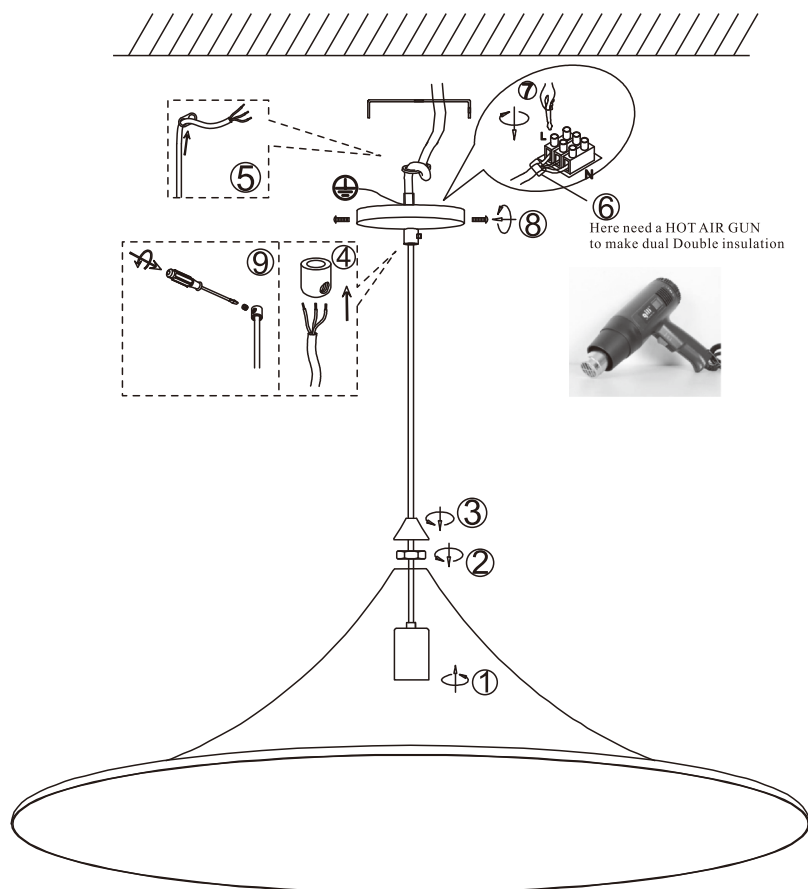

- Ensure the main supply is switched off at the mains.
- Unpack the pendant lamp carefully and place it on a flat surface.
- Pass the lamp holder cables (1) through the shade, fasten securely using the provided screws (2)
- Slide the shade cover (3) onto the cable.
- Thread the wires through the cord grip (4) on the ceiling rose.
- Secure wires using the provided plastic cord holder (5)
- Connect main power supply wires to terminal block (brown - live, blue - neutral, green/yellow - earth) making sure all connections are tight. (6,7)
- Install the mounting bracket onto the ceiling by using wall plugs and screws. Install ceiling rose onto the mounting bracket and secure by tightening the screws on the sides. (8)
- Tighten screw clockwise until secure (9).
- Install the bulb (not included) into lampholder
- Reconnect power.
- Light source: E27 60W MAX.

#### WARNING:

- This fitting must be earthed.
- Not for outdoor use or in wet conditions.
- Disconnect power and allow fitting to cool down before cleaning or changing the lamp.